



FIDO PLATFORM FEATURES

LIFT SPECIFICATIONS

FIDO CLASSIC constant pressure operation and universal operation at landings

without cabin doors

Max rated load **500 Kg**

1 or 2 swing doors at landings

Speed 0,15 m/s - power supply 230 V single phase

Min head with masonry shaft 2250 mm standard 2500 mm

Min head with structural tower 2350 mm standard 2600 mm

Min pit **140 mm**



FIDO EASY universal operation

automatic cabin folding doors

Max rated load **500 Kg**

1 or 2 swing doors at landings

Speed 0,15 m/s - power supply 230 V single phase

Min head with masonry shaft 2600 mm

Min head with structural tower 2700 mm

Min pit **140 mm**

FIDO PLUS universal operation

automatic cabin and landing doors

Max rated load **500 Kg**

Automatic cabin doors (2AT-2AO-3AT-4AO)

Automatic landing doors (2AT-2AO-3AT-4AO)

Speed 0,15 m/s - power supply 230 V single phase

Min head with masonry shaft 2500 mm

Minhead with structural tower 2600 mm

Min pit **140 mm**



FIDO KARGO universal operation

WITHOUT PASSENGERS IN CABIN - without cabin doors

Max rated load **500 Kg**

1 or 2 swing doors at landings

with or without stop charge

return push button at landings

Min head with masonry shaft 2500 mm

Min head with structural tower 2600 mm

Speed 0,15 m/s - **min pit 140 mm**

Speed 0,30 m/s - **min pit 260 mm**

FIDO PLATFORM FEATURES

SOME PICTURES OF STRUCTURAL TOWERS FOR THE FIDO PLATFORM

New structural tower model



Outside dimensions of the structural tower min 770 mm

FIDO PLATFORM FEATURES

SOME PICTURES OF FIDO PLATFORM WE MANUFACTURED



FIDO PLATFORM FEATURES

SOME PICTURES OF THE FIDO PLATFORM CABINS



Margherita cabin with walls in melamine and parquette flooring



Cabin in plastic laminate and one panoramic wall energy saving lights



Cabin in wood with horizontal trims scotch brite stainless steel finishings



Panoramic cabin, black mirror stainless steel finishings, LED spots horizontal station panel



Cabin in plastic laminate finishing similar inox



Cabin in radica wood, finishings in stainless steel mirror

FIDO PLATFORM FEATURES

SOME PICTURES OF THE SEMIAUTOMATIC LANDING DOORS FOR THE FIDO PLATFORM



Semiautomatic swing door
rail painted finishing
door with diamonds



Semiautomatic swing door
rail painted finishing
door with ellisse



Semiautomatic swing door
rail painted finishing
panoramic door



Semiautomatic swing door
rail painted finishing
bund door



Semiautomatic swing door
total glass - antiskid glass
golden stainless steel frame

Please contact our sale department
should you need other door types
as to the solutions showed

FIDO PLATFORM FEATURES

SOME PICTURES OF THE AUTOMATIC LANDING DOORS FOR THE FIDO PLATFORM



**Automatic two swing doors
in transparent glass with frame**



**Automatic telescopic doors antirust version painting
as per customer's choice**



**Automatic telescopic doors
total glass**



**Automatic telescopic doors
in glass with frame**

FIDO PLATFORM FEATURES

SAFETY DEVICES

All our Fido platform are equipped with a **HLB patented** device in order to enable entering the shaft in safety conditions

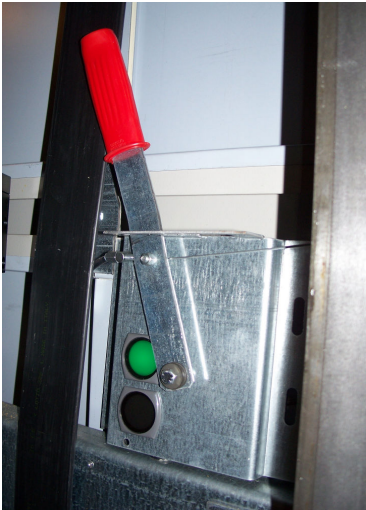

before entering into the shaft secure the elevator with a simple move









in case the cabin runs down the device activates the safety instruments

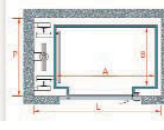

FIDO PLATFORM FEATURES

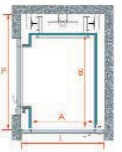
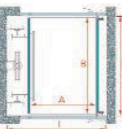
STANDARD DIMENSIONS OF THE PLATFORM "FIDO CLASSIC" WITH MASONRY SHAFT

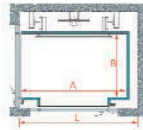
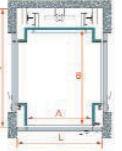
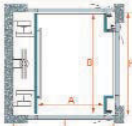





| | | SHAFT DIMENSIONS | CABIN DIMENSIONS | ENTRANCES | DOOR OPENING |
|-------------|---|----------------------|--------------------|-----------|--------------------|
| CD FM PX 1F |  | 1.060 x 1.555 | 800 x 1.250 | 1 | 800 x 2.000 |
| CD FM LX 1F |  | 1.215 x 1.350 | 800 x 1.250 | 1 | 800 x 2.000 |
| CD FM LY 1F |  | 1.625 x 1.010 | 1.250 x 800 | 1 | 800 x 2.000 |
| CD FM PY 1F |  | 1.410 x 1.215 | 1.250 x 800 | 1 | 800 x 2.000 |
| CD FM PO 1F |  | 1.060 x 955 | 800 x 650 | 1 | 800 x 2.000 |
| CD FM PX 2A |  | 1.010 x 1.555 | 800 x 1.250 | 2 | 800 x 2.000 |
| CD FM LX 20 |  | 1.215 x 1.290 | 800 x 1.250 | 2 | 800 x 2.000 |
| CD FM LY 20 |  | 1.625 x 1.060 | 1.250 x 800 | 2 | 800 x 2.000 |
| CD FM PY 2A |  | 1.350 x 1.215 | 1.250 x 800 | 2 | 800 x 2.000 |
| CD FM PX 3I |  | 1.060 x 1.555 | 800 x 1.250 | 3 | 800 x 2.000 |
| CD FM PY 3I |  | 1.215 x 1.290 | 800 x 1.250 | 3 | 800 x 2.000 |

For special dimensions please contact our sale department

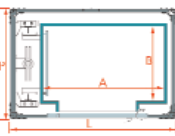
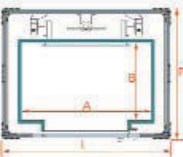
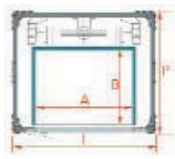

FIDO PLATFORM FEATURES

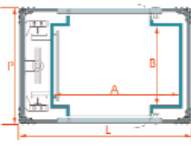
STANDARD DIMENSIONS OF THE PLATFORM "FIDO CLASSIC" WITH STRUCTURAL TOWER

| | | | | | |
|--------------------|---|--|--|-----------------------|------------------------------------|
| CD FI PX 1F |  | SHAFT DIMENSIONS 1.100 x 1.660 | CABIN DIMENSIONS 800 x 1.250 | ENTRANCES 1 | DOOR OPENING 800 x 2.000 |
| CD FI LX 1F |  | SHAFT DIMENSIONS 1.300 x 1.450 | CABIN DIMENSIONS 800 x 1.250 | ENTRANCES 1 | DOOR OPENING 800 x 2.000 |
| CD FI LY 1F |  | SHAFT DIMENSIONS 1.750 x 1.110 | CABIN DIMENSIONS 1.250 x 800 | ENTRANCES 1 | DOOR OPENING 800 x 2.000 |
| CD FI PY 1F |  | SHAFT DIMENSIONS 1.510 x 1.305 | CABIN DIMENSIONS 1.250 x 800 | ENTRANCES 1 | DOOR OPENING 800 x 2.000 |
| CD FI PO 1F |  | SHAFT DIMENSIONS 1.140 x 1.055 | CABIN DIMENSIONS 800 x 650 | ENTRANCES 1 | DOOR OPENING 800 x 2.000 |
| CD FI PX 2A |  | SHAFT DIMENSIONS 1.120 x 1.660 | CABIN DIMENSIONS 800 x 1.250 | ENTRANCES 2 | DOOR OPENING 800 x 2.000 |
| CD FI LX 20 |  | SHAFT DIMENSIONS 1.300 x 1.390 | CABIN DIMENSIONS 800 x 1.250 | ENTRANCES 2 | DOOR OPENING 800 x 2.000 |
| CD FI LY 20 |  | SHAFT DIMENSIONS 1.750 x 1.160 | CABIN DIMENSIONS 1.250 x 800 | ENTRANCES 2 | DOOR OPENING 800 x 2.000 |
| CD FI PY 2A |  | SHAFT DIMENSIONS 1.450 x 1.305 | CABIN DIMENSIONS 1.250 x 800 | ENTRANCES 2 | DOOR OPENING 800 x 2.000 |

For special dimensions please contact our sale department



Our platform

FIDO PLATFORM FEATURES

STANDARD DIMENSIONS OF THE PLATFORM "FIDO EASY" WITH MASONRY SHAFT

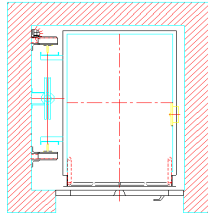

A

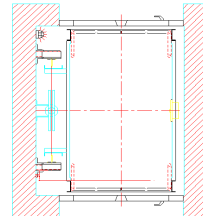

B

| | | | | |
|----------|---|--|------------------------------|---|
| A | SHAFT DIMENSIONS 1.245 x 1.440 | CABIN DIMENSIONS 860 x 1200 | ENTRANCES 1 | DOOR OPENING 800 x 2.000 |
| B | SHAFT DIMENSIONS 1.245 x 1.520 | CABIN DIMENSIONS 860 x 1200 | ENTRANCES 2 | DOOR OPENING 800 x 2.000 |

STANDARD DIMENSIONS OF THE PLATFORM "FIDO EASY" WITH STRUCTURAL TOWER

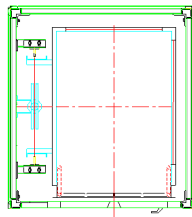

C

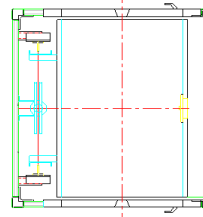

D

| | | | | |
|----------|---|--|------------------------------|---|
| C | SHAFT DIMENSIONS 1.355 x 1.540 | CABIN DIMENSIONS 860 x 1200 | ENTRANCES 1 | DOOR OPENING 800 x 2.000 |
| D | SHAFT DIMENSIONS 1.355 x 1.620 | CABIN DIMENSIONS 860 x 1200 | ENTRANCES 2 | DOOR OPENING 800 x 2.000 |

contact our sale department

For special dimensions please



FIDO PLATFORM FEATURES

STANDARD DIMENSION OF THE PLATFORM "FIDO PLUS" WITH MASONRY SHAFT

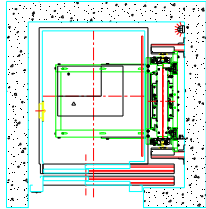

A

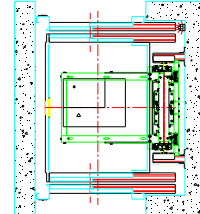

B

| | SHAFT DIMENSIONS | CABIN DIMENSIONS | ENTRANCES | DOOR OPENING |
|----------|----------------------|--------------------|-----------|--------------------|
| A | 1.330 x 1.500 | 800 x 1200 | 1 | 750 x 2.000 |
| B | 1.330 x 1.640 | 800 x 1200 | 2 | 750 x 2.000 |
| A | 1.450 x 1.650 | 950 x 1300 | 1 | 800 x 2.000 |
| | 1.500 x 1.650 | 950 x 1300 | 1 | 850 x 2.000 |
| | 1.550 x 1.650 | 950 x 1300 | 1 | 900 x 2.000 |
| B | 1.450 x 1.820 | 950 x 1300 | 2 | 800 x 2.000 |
| | 1.500 x 1.820 | 950 x 1300 | 2 | 850 x 2.000 |
| | 1.550 x 1.820 | 950 x 1300 | 2 | 900 x 2.000 |
| A | 1.600 x 1.750 | 1100 x 1400 | 1 | 800 x 2.000 |
| | 1.600 x 1.750 | 1100 x 1400 | 1 | 850 x 2.000 |
| | 1.600 x 1.750 | 1100 x 1400 | 1 | 900 x 2.000 |
| B | 1.600 x 1.920 | 1100 x 1400 | 2 | 800 x 2.000 |
| | 1.600 x 1.920 | 1100 x 1400 | 2 | 850 x 2.000 |
| | 1.600 x 1.920 | 1100 x 1400 | 2 | 900 x 2.000 |

For special dimensions please contact our sale department



Our platform

FIDO PLATFORM FEATURES

STANDARD DIMENSIONS OF THE PLATFORM "FIDO PLUS" WITH STRUCTURAL TOWER

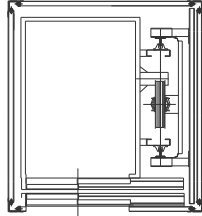

A

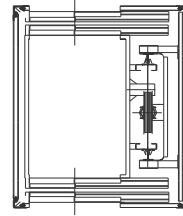

B

| | | | | |
|----------|--|--|-----------------------|------------------------------------|
| A | SHAFT DIMENSIONS 1.370 x 1.600 | CABIN DIMENSIONS 800 x 1200 | ENTRANCES 1 | DOOR OPENING 750 x 2.000 |
| B | SHAFT DIMENSIONS 1.370 x 1.720 | CABIN DIMENSIONS 800 x 1200 | ENTRANCES 2 | DOOR OPENING 750 x 2.000 |
| A | SHAFT DIMENSIONS 1.450 x 1.750 | CABIN DIMENSIONS 950 x 1300 | ENTRANCES 1 | DOOR OPENING 800 x 2.000 |
| | 1.520 x 1.750 | 950 x 1300 | 1 | 850 x 2.000 |
| | 1.600 x 1.750 | 950 x 1300 | 1 | 900 x 2.000 |
| B | SHAFT DIMENSIONS 1.450 x 1.820 | CABIN DIMENSIONS 950 x 1300 | ENTRANCES 2 | DOOR OPENING 800 x 2.000 |
| | 1.520 x 1.820 | 950 x 1300 | 2 | 850 x 2.000 |
| | 1.600 x 1.820 | 950 x 1300 | 2 | 900 x 2.000 |
| A | SHAFT DIMENSIONS 1.600 x 1.830 | CABIN DIMENSIONS 1100 x 1400 | ENTRANCES 1 | DOOR OPENING 800 x 2.000 |
| | 1.600 x 1.830 | 1100 x 1400 | 1 | 850 x 2.000 |
| | 1.600 x 1.830 | 1100 x 1400 | 1 | 900 x 2.000 |
| B | SHAFT DIMENSIONS 1.600 x 1.920 | CABIN DIMENSIONS 1100 x 1400 | ENTRANCES 2 | DOOR OPENING 800 x 2.000 |
| | 1.600 x 1.920 | 1100 x 1400 | 2 | 850 x 2.000 |
| | 1.600 x 1.920 | 1100 x 1400 | 2 | 900 x 2.000 |

For special dimensions please contact our sale department

BEFORE AND AFTER COMPLETE MANAGEMENT BY OXFORD LIFTS



Single phase hydraulic replacements for Shepard Home Lifts. In self supporting structure or special adaptations for extra tight breeze block shafts. 2500mm Headroom 180mm pit

